

Accessories & Attachments

ATTACHMENT	RECOMMENDED USE
 High Pressure Steam Nozzle	Ideal for most cleaning applications (e.g., countertops, sinks, door handles, etc.)
 Nylon Brush	Can be used to remove more stubborn stains, to clean grout lines, etc.
 Brass Brush	Ideal for metal safe/scratch resistant surfaces (e.g., BBQs & grills)
 Microfiber Steam Mop Pad	Ideal for floor cleaning. Suitable for ceramic, tile, marble, laminate, stone & sealed hardwood floors. Mop pads are machine washable
 Carpet Glide	Can be used to steam clean your carpets. Also suitable for steam cleaning sofas and other pieces of upholstery

Troubleshooting

**My Pronto unit keeps making a chugging sound**  
If your unit is making a chugging sound upon initial startup, this is the water drawing into the unit. Wait until the unit is fully activated and the chugging sound will stop. If your unit is making the chugging sound after you've already started up your unit, perhaps the water tank is close to empty. Refill your water tank before further cleaning.

**My Pronto's steam-ready light keeps flashing**  
If the steam-ready light on your Pronto Plus 300CS keeps flashing, this may indicate that the unit is reheating. Wait until the unit has reheated prior to continuing your cleaning regimen.

**My Pronto is leaking water**  
Check the water tank cap to make sure it is secure. If not, close rubber lid securely and ensure that the surrounding area is dry. Also be sure not to overfill water tank in order to avoid leakage.

**My Pronto 300CS is producing reduced/no steam**  
If your Pronto Plus 300CS is not producing any steam, or producing very little, first check that your unit is on and wait until the steam-ready light is a solid color. Another possible cause is that the water tank is empty. Check your water tank level to see if the unit requires more water. Always ensure to unplug your Pronto prior to filling it with water.

For more information on your product,  
to view instructional videos or to  
download the full user manual, visit  
[reliablecorporation.com](https://reliablecorporation.com)



**Having trouble? Call us.**  
For service and/or technical assistance  
on this product, call our toll free  
number or email our support staff

**1-800-268-1649**  
[support@reliablecorporation.com](mailto:support@reliablecorporation.com)

PRONTO PLUS 300CS



QUICK START GUIDE



## What's Inside

1	Pronto Plus 300CS Body	7	30mm Nylon Brush x2
2	Mop Extension Handle	8	30mm Brass Brush x2
3	Steam Mop Base	9	60mm Nylon Brush x2
4	Microfiber Steam Mop Pad x2	10	Accessory Storage Bag
5	Carpet Glide	11	Wall Mount
6	High Pressure Steam Nozzle	12	Wall Anchor x4 & Screws x4

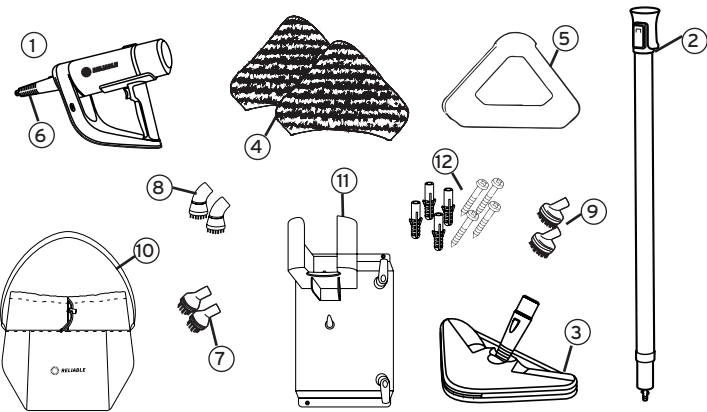

## Getting Started

- 1 Push the unlock button at the top of the unit to release the water tank.

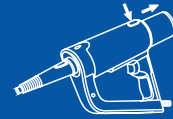

- 2 Lift open the rubber cap lid. Fill water tank with water, careful not to overfill. Close rubber cap securely to avoid any leaks.



- 3 Attach water tank back onto Pronto unit. You will hear a faint click when it is securely in place.

- 4 Based on your cleaning needs, connect the desired attachment to the front of your unit.



- 5 Plug your system into a suitable outlet. Once plugged in, the light at the front of the unit will flash. Wait up to 30 seconds until the light turns a solid color. Once a solid color appears, the system is ready for use.

- 6 Push the trigger on the handle once to release steam. To stop steam output, push trigger again. No need to hold down on the steam button.

**\*Note** when pushing the button to stop steam, it may take a few seconds for all of the water to release

- 7 When you are finished your cleaning regimen, be sure to unplug the device.



## Using Your Steam Mop

- 1 Attach your mop extension handle to the Pronto Plus 300CS body by snapping it into place.

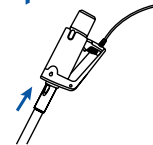

- 2 Attach your steam cleaning unit to the mop base by clicking it into place.

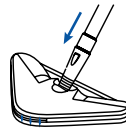

- 3 Align your mop base to the steam mop pad and press firmly into place.

**\*Note** upon initial use of your mop pad, add two tablespoons of water directly onto the pad to create moisture. This is only necessary for first time use.

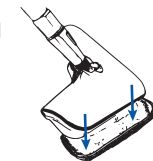

- 4 Attach your carpet glide overtop the steam mop pad. Insert the steam mop front first into the carpet glide. Push down to secure.

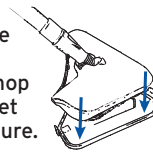

- 5 Push the trigger on the handle once to release steam.

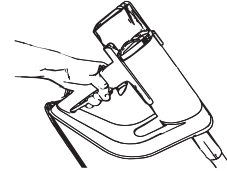

- 6 Slowly and evenly, run your steam mop back and forth over the desired area using continuous steam.

**\*Note** do not steam one section for prolonged periods of time, as this may cause damage to your floors.

## Using Your Handheld Steamer

- 1 Connect the desired tool at the front of your Pronto unit based on your cleaning needs.

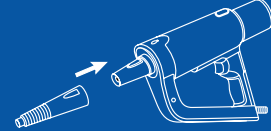

**\*Note** ensure you have given your system enough time to cool down prior to changing the attachments.

- 2 If you are using the high pressure steam nozzle, place your Pronto 1-2 inches away from the area that you would like to clean. Push the trigger once to release steam and move the unit slowly back and forth.

- 3 If you are using one of the provided brush attachments, use continuous steam while scrubbing the desired area. Be careful not to stay in one place for too long, to avoid any damage to the area.

## Maintenance

- 1 Ensure that the unit has cooled off completely.

- 3 Wipe surface of machine with a soft, clean cloth.



- 2 Empty the tank of any residual water.



- 4 Allow time for product to dry before storing.